

## COS ROUND BOTTLE TRAP - BRUSHED BRONZE

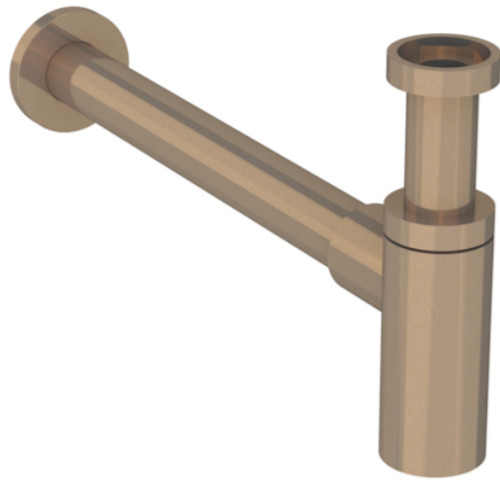

### PRODUCT INFORMATION

|                  |                      |
|------------------|----------------------|
| <b>Finish:</b>   | Brushed Bronze (PVD) |
| <b>Height:</b>   | 197mm                |
| <b>Width:</b>    | 70mm                 |
| <b>Depth:</b>    | 377mm                |
| <b>Material:</b> | Brass                |
| <b>Weight:</b>   | 0.68kg               |

**Product Code:** CO9570.BR

### DESCRIPTION

The COS collection was designed to create brassware that was both modern and classic to suit any style of bathroom.

A COS bottle trap in Satin Black is the perfect finishing touch to your bathroom. If you're opting for a wall mounted washbasin on its own, a bottle trap will instantly give it a sophisticated look whilst still providing practicality. It can be cut down in height and in projection, so you can make sure it precisely connects with your basin and basin waste.

The Satin Black finish is PVD, a durable coating to the finish that will continuously look flawless for years to come.

### TECHNICAL DRAWING

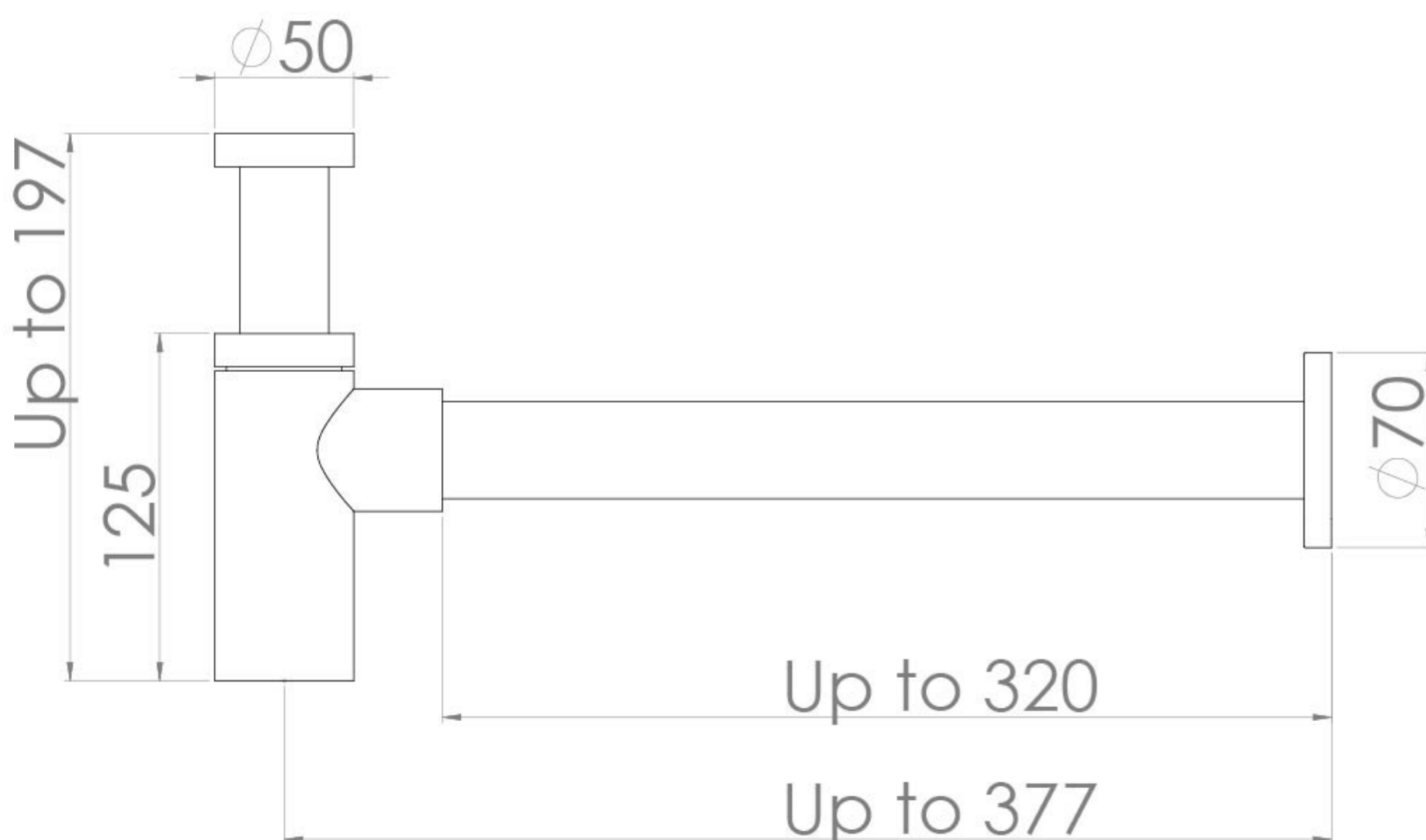

Saneux reserves the right to alter the specifications and product range without prior notice. Dimensions are given as a guide only. Dimensions should not be used for surrounding furniture, fixtures and fittings until the product is on site.