

# COS 3 PIECE WALL MOUNTED BASIN MIXER - MATTE BLACK



Product Code: CO207.MB

## PRODUCT INFORMATION

|                       |                                                       |
|-----------------------|-------------------------------------------------------|
| Width:                | 298mm                                                 |
| Finish:               | Matte Black (Electroplated)                           |
| Height:               | 27.5mm                                                |
| Depth:                | 191mm                                                 |
| Material:             | Brass                                                 |
| Product Type:         | Wall Mounted Basin Mixer Tap, 3 Piece Basin Mixer Tap |
| Guarantee             | 5 years                                               |
| Weight                | 3kg                                                   |
| Waste                 | Not included, purchase separately                     |
| Spout Projection (mm) | 191mm                                                 |
| Other Features        | Pair with a 0 tap hole or countertop basin            |
| Material              | Brass                                                 |

## DESCRIPTION

The COS collection was designed to create brassware that was both modern and classic to suit any style of bathroom.

This COS 3 piece wall mounted basin mixer in matte black is a great option and will perfectly match any of our ceramic and furniture ranges.

Waste to be purchased separately.

TECHNICAL DRAWING

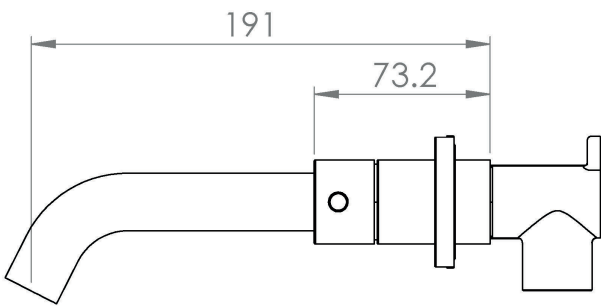
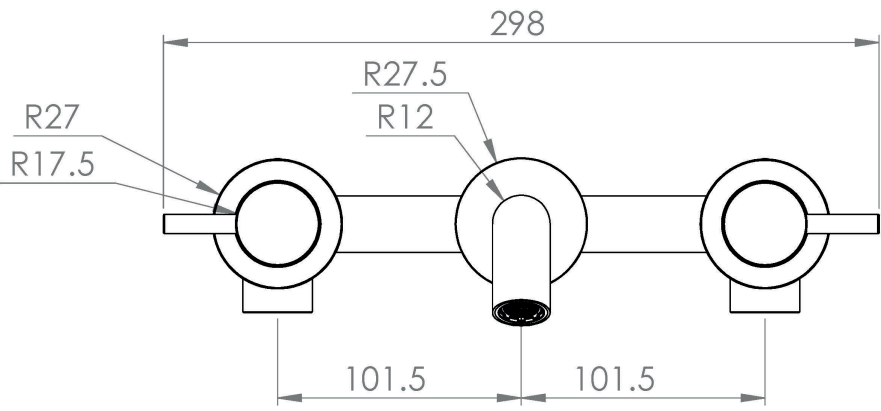

FLOW RATE

- 0.2 Bar - Flowrate: 3.59 l/min
- 0.3 Bar - Flowrate: 4.1 l/min
- 0.5 Bar - Flowrate: 5.3 l/min
- 1 Bar - Flowrate: 7.45 l/min
- 2 Bar - Flowrate: 10.7 l/min
- 3 Bar - Flowrate: 13.2 l/min
- 5 Bar - Flowrate: 17.3 l/min

Saneux reserves the right to alter the specifications and product range without prior notice. Dimensions are given as a guide only. Dimensions should not be used for surrounding furniture, fixtures and fittings until the product is on site.