

AFTERCARE INSTRUCTIONS

When using chlorine-based cleaners to clean the pan bowl, ensure that these do not come into contact with the seat. Keep the seat and cover in an upright position during cleaning to avoid discolouration of surfaces or rusting of metal parts.

CUSTOMER SERVICE

t: +44(0)208 686 5100
e: technical@saneux.com

4 Imperial Way
Croydon CR0 4RR

www.saneux.com

INDIGO

INSTALLATION INSTRUCTIONS

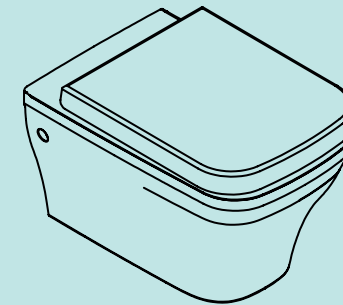

70117

saneux

1. Measure the total height of the pan from the floor (recommended height 420mm) and remove the distance between the top and the bolt holes. Install the cistern and connecting pipework at the measured heights. Test the cistern prior to installing the pan to ensure there are no leaks or issues with the flushing. Check that you have the pan fixings

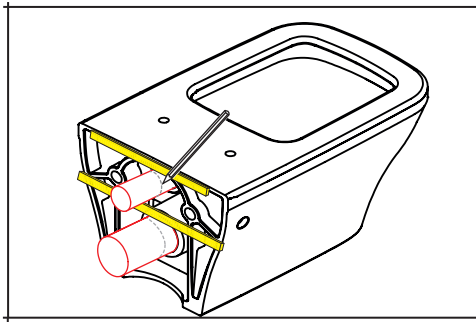
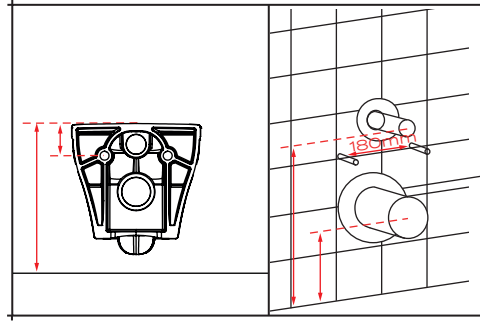

2. Place the Inlet and outlet pipes on the Wc pan and mark where they extend past the edges of the bowl.

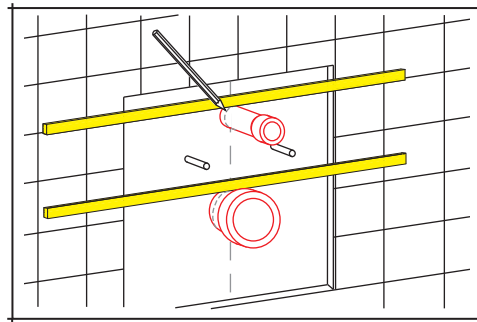

3. Place the pipes completely onto the framed cistern and mark them where they emerge from the unit.

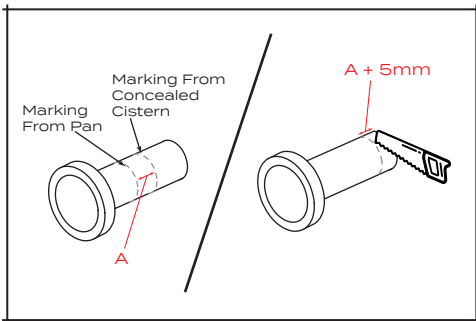

4. Measure the space between the marks on the pipes (distance A), carry this measurement over to the end of the pipes, adding 5mm and then cut off the end. Then use a file to smooth the pipe ends, before securing the pipes into the cistern unit.

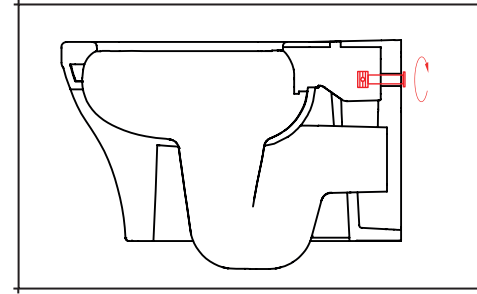

5. Install the fixing kit onto the back of the pan.

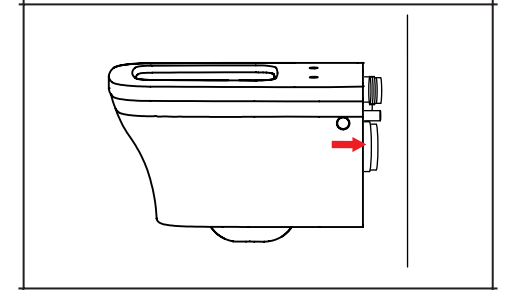

6. Place the pan on the wall through the carrier holes and bolts on the framed cistern.

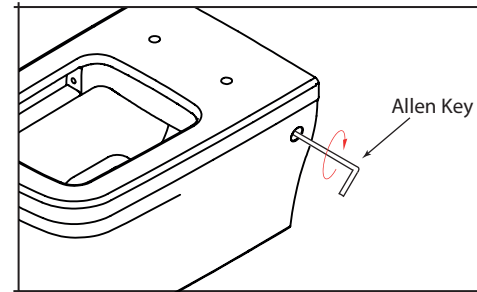

7. Use the provided allen key to firmly tighten the toilet to the framed cistern. Flush the system and check for any leaks.

8. Add a consistent line of silicone sealant around the back of the pan, creating a watertight seal between the pan and the wall. Allow to cure for 24hr before wetting. Place the cover caps provided over the holes on the side of the pan.

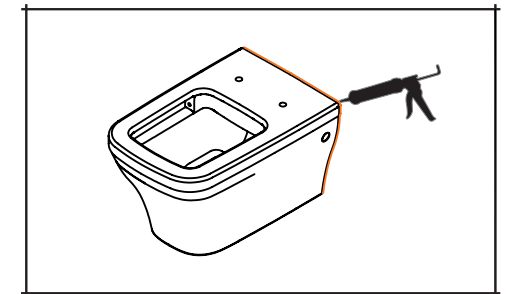

9. Install the seat according to the fitting instructions included in the seat's box.